

Chromed Brake Pedal Fitting Instructions - Thunderbird & Adventurer



WARNING: Always have Triumph approved parts, accessories and conversions fitted by a trained technician of an authorised Triumph dealer. The fitment of parts, accessories and conversions by a technician who is not of an authorised Triumph dealer may affect the handling, stability or other aspects of the motorcycle operation which may result in an accident causing injury or death.



WARNING: Throughout this operation, ensure that the motorcycle is stabilised and adequately supported on a paddock stand to prevent the risk of injury from the motorcycle falling.

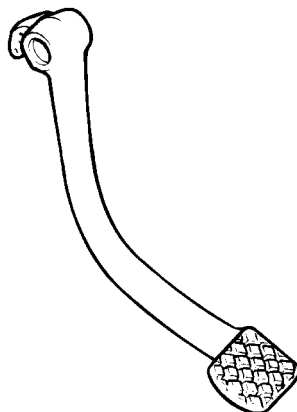

WARNING: This brake pedal is designed for use solely on Triumph Thunderbird and Adventurer motorcycles and should not be fitted to any other Triumph model or to any motorcycles of other manufacturers. Fitting this brake pedal to any other Triumph model or to any motorcycles of other manufacturers may interfere with the rider and could affect the stability and handling of the motorcycle leading to an accident causing injury or death.

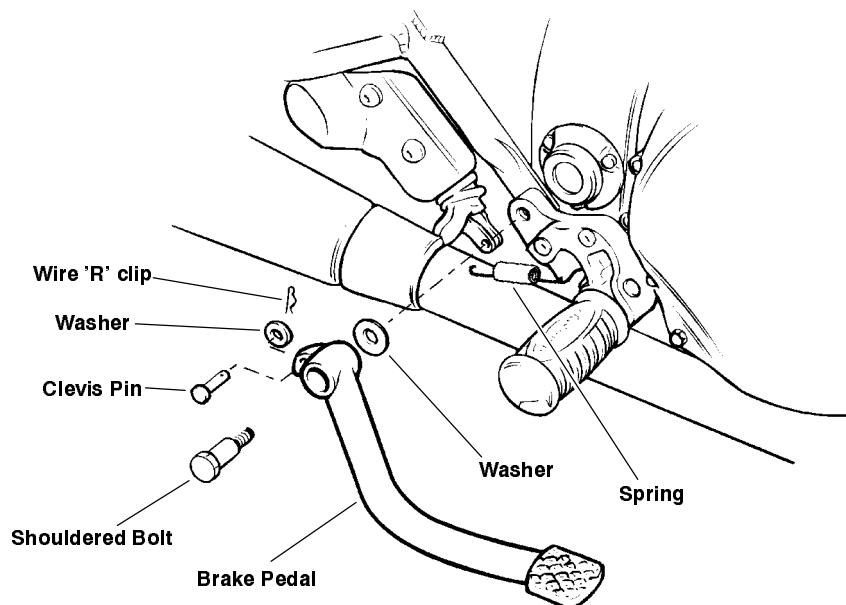

1. Refer to the diagram above. Remove the wire 'R'-clip from the clevis pin. Remove the clevis pin and collect the washer.

NOTE: Later models may be fitted with a grooved clevis pin and a slot-type clip.

2. Refer to the diagram above. Remove the shouldered bolt and detach the spring from the brake pedal. Remove the brake pedal and collect the washer.

NOTE: The brake pedal will not be refitted but should be retained for future re-use if the chromed brake pedal is ever removed.

3. Attach the spring to the chromed brake pedal. Align the washer and brake pedal as shown in the diagram above. Refit the shouldered bolt and tighten to 27 Nm.

Chromed Brake Pedal Fitting Instructions - Thunderbird & Adventurer



4. Connect the master cylinder pushrod to the chromed brake pedal using the clevis pin. Refit the washer and retain with the wire 'R'-clip (or slot-type clip).

NOTE: Ensure that the forked end of the pushrod is fitted such that it sits astride the actuating point on the brake pedal.

5. Check that the height of the foot-plate on the rear brake pedal is sufficiently below the height of the footrest to prevent accidental application during normal riding. If necessary, refer to the diagram below and adjust as follows:-

NOTE: It is not necessary to remove the rod from the pedal to make the adjustments.

- Retract the rubber gaiter covering the master cylinder push rod.
- Slacken the locknut and turn the pushrod until the required pedal height is reached.
- Re-tighten the locknut when the pedal is set to the required height.
- Refit the rubber gaiter.

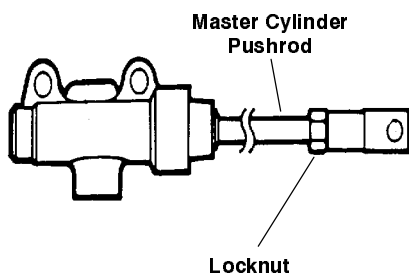

WARNING: Ensure that the master cylinder rod has adequate thread engagement in the clevis pin fork (minimum 10mm).

A dangerous riding condition leading to an accident could result if this warning is ignored.



WARNING: After adjusting the pedal, operate the motorcycle in a safe area away from traffic to gain familiarity with the new pedal setting.

Operation of the motorcycle without first becoming familiar with the new pedal setting could lead to loss of control and an accident.