

# Auxiliary Power Socket Fitting Instructions - Rocket III



**Warning**

Always have Triumph approved parts, accessories and conversions fitted by a trained technician of an authorised Triumph Dealer. The fitment of parts, accessories and conversions by a technician who is not of an authorised Triumph dealer may affect the handling, stability or other aspects of the motorcycles operation which may result in an accident causing injury or death.

**Warning**

This auxiliary power socket kit is designed for use on Triumph motorcycles only and should not be fitted to any other Triumph model or to any other manufacturers motorcycle. Fitting this auxiliary power socket kit to any other Triumph model or to any other manufacturers motorcycle, may interfere with the rider and could affect the stability and handling of the motorcycle leading to an accident causing injury or death.

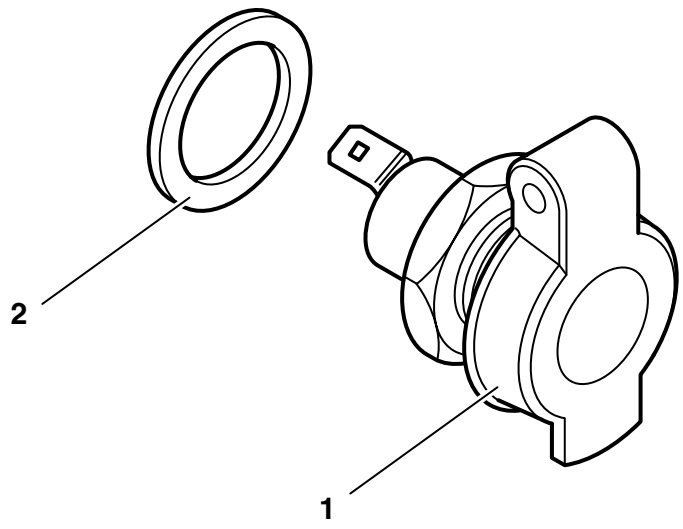

### Parts Supplied:

- 1. Auxiliary power socket ..... 1 off
- 2. Washer ..... 1 off

# Auxiliary Power Socket Fitting Instructions - Rocket III



## ⚠ Warning

Ensure that the motorcycle is stabilised and adequately supported, to prevent it from falling and causing damage or injury.

1. Position the motorcycle on a paddock stand.
2. Remove the seat and disconnect the battery, negative (black) lead first.
3. Refer to the illustration below and remove the two fixings securing the left hand frame infill panel to the motorcycle. Remove the infill panel from the motorcycle.

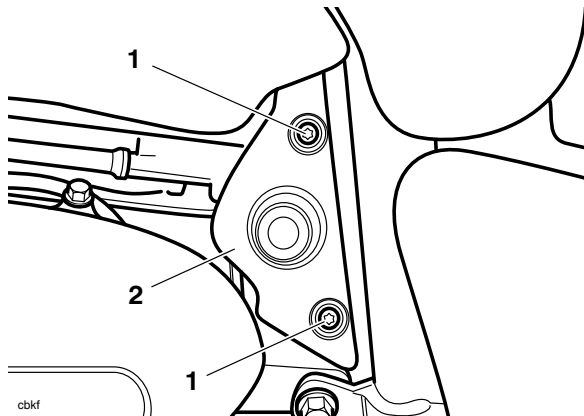

1. Fixing
2. Infill panel

4. Push the blanking plug out of the infill panel.

### NOTE

- The blanking plug will not be refitted but should be retained for future re-use if the auxiliary power socket kit is ever removed.

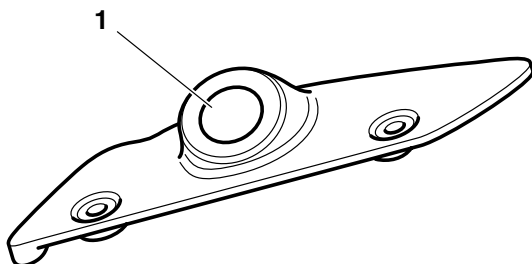

cbkg

1. Blanking plug

5. Fit the auxiliary power socket to the infill panel as shown below using the washer provided in the kit and the nut to secure. Tighten the nut to **5 Nm**.

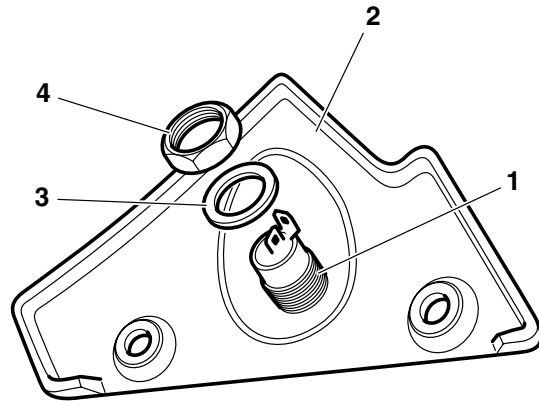

cbkh

1. Auxiliary power socket
2. Infill panel
3. Washer
4. Nut

6. Locate the two-pin electrical connector marked with blue tape in the main wiring harness. The connector is situated in the area which was covered by the left hand frame infill panel. Fit the connector to the back of the auxiliary power socket.
7. Refit the left hand frame infill panel to the motorcycle. Tighten the two fixings to **4 Nm**.

## ⚠ Caution

When refitting the left hand frame infill panel, route cables to follow the main wiring harness and ensure no cables can be trapped by the infill panel.

Failure to observe this caution may result in short circuits, a burnt out wiring harness and the possibility of fire.

8. Reconnect the battery, positive (red) lead first.
9. Refit the seat.
10. Remove the paddock stand.