

**Fitting Instructions:
Speed Triple 1050
Riser kit - A9638021**



Warning

Always have Triumph approved parts, accessories and conversions fitted by a trained technician of an authorised Triumph dealer. The fitment of parts, accessories and conversions by a technician who is not of an authorised Triumph dealer may affect the handling, stability or other aspects of the motorcycles operation which may result in loss of motorcycle control and an accident.

Warning

This accessory kit is designed for use on Triumph Speed Triple 1050 motorcycles only and should not be fitted to any other Triumph model or to any other manufacturers motorcycle. Fitting this accessory kit to any other Triumph model, or to any other manufacturers motorcycle, may interfere with the rider and could affect the handling, stability or other aspects of the motorcycles operation which may result in loss of motorcycle control and an accident.

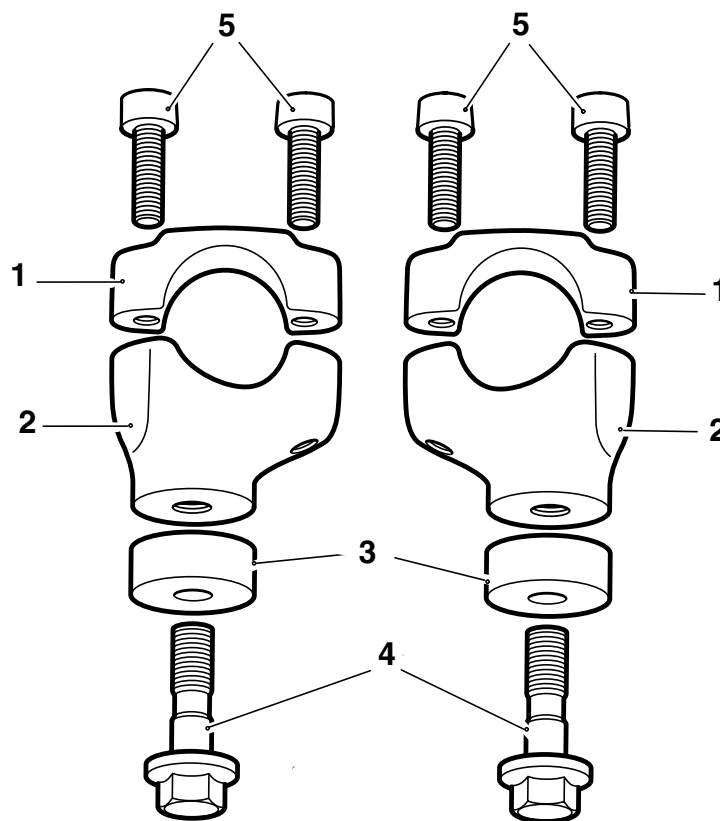

T0034a

Parts Supplied:

- | | | | |
|---|--------------|---|--------------|
| 1. Riser clamp (upper) | 2 off | 4. Bolt - M10 x 35 (patch lock) . . | 2 off |
| 2. Riser clamp (lower) | 2 off | 5. Screw - M8 x 35 socket cap head . . | 4 off |
| 3. Spacer | 2 off | | |

Warning

Throughout this operation, ensure that the motorcycle is stabilised and adequately supported on a paddock stand to prevent risk of injury from the motorcycle falling.

Warning

A torque wrench of known accurate calibration must be used when fitting this accessory kit. Failure to tighten any of the fasteners to the correct torque specification may affect motorcycle performance, handling and stability. This may result in loss of motorcycle control and an accident.

NOTE

- **This riser kit is to be used with Triumph oversized handlebar kits A9638017 & A9630031.**

NOTE

- **Completely read all the instructions before commencing the installation of the accessory kit in order to become thoroughly familiar with the kit's features and the installation process.**

1. Remove the levers, mirrors, switch cubes, bar end weights, grips and handlebars as described in the service manual.
2. Remove the risers from the top yoke as shown below. Retain the risers and fixings if the motorcycle is to be returned to the original condition.
3. Fit the new riser lower clamps to the top yoke with the spacers positioned correctly and the riser clamp in the correct orientation as shown below.

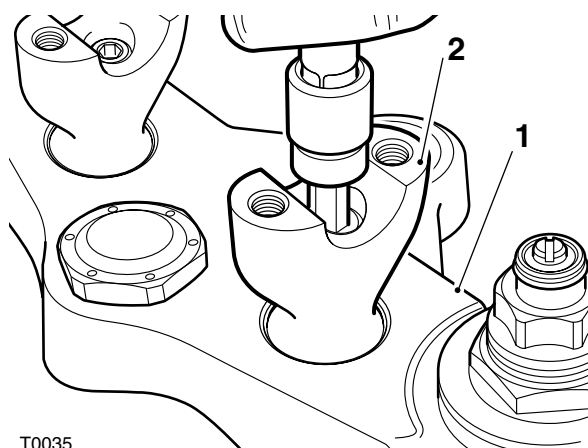

T0035

1. Top yoke
2. Riser

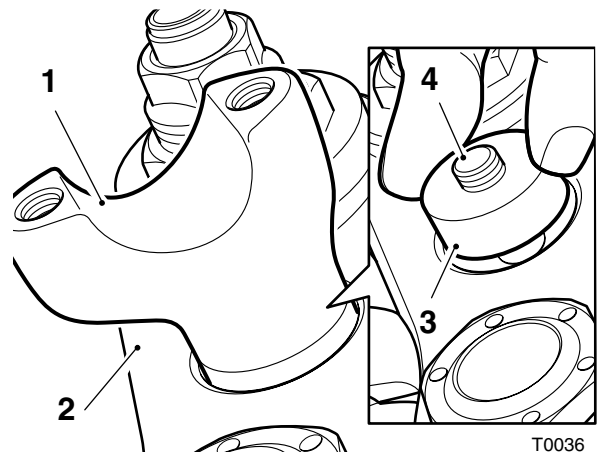

T0036

1. Riser lower clamp
2. Top yoke
3. Spacer
4. Fixing bolt

4. Place the oversize handlebars in position on the bottom riser clamp with the Triumph logo at the top. Fit the riser upper clamps and four fixing screws loosely at this stage.

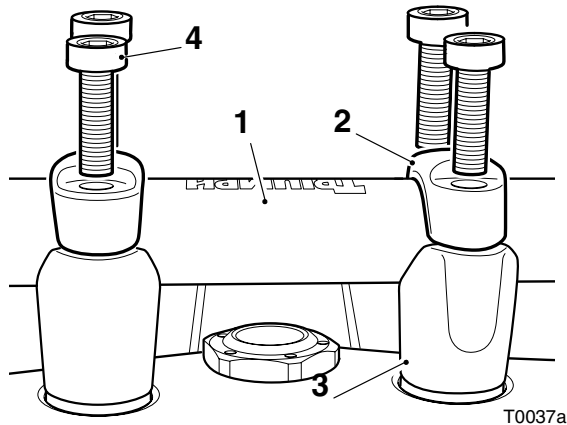

1. Oversize handlebars
2. Riser upper clamp
3. Riser lower clamp
4. Fixing screw

6. Align the dots on the handlebars with the split line of the risers, as shown below, and tighten the four fixings to a torque value of **26Nm**.

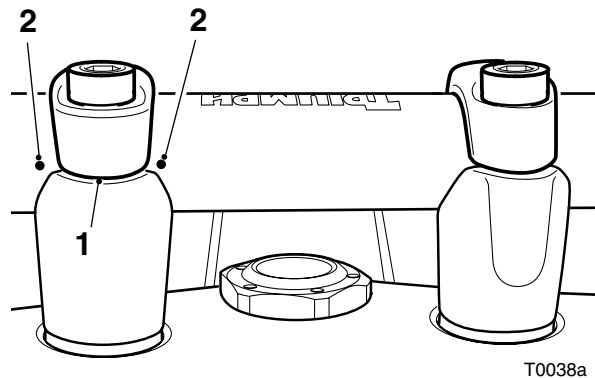

1. Split line
2. Alignment dot

5. Tighten the lower riser clamp fixings to a torque value of **45Nm**.

7. Refit the switch cubes, levers, mirrors, grips and bar end weights as described in the service manual.

Warning

After fitting the accessory kit the motorcycle will exhibit new handling characteristics. Operate the motorcycle in a safe area free from traffic to gain familiarity with any new characteristics. Operation of the motorcycle when not familiar with any new handling characteristics may result in loss of motorcycle control and an accident.

Warning

This motorcycle must not be operated above the legal road speed limit except in authorised closed course conditions.

Warning

Only operate this Triumph motorcycle at high speed in closed-course on road competition or on closed course racetracks. High speed operation should only be attempted by riders who have been instructed in the techniques necessary for high speed riding and are familiar with the motorcycle's characteristics in all conditions. High speed operation in any other circumstances is dangerous and will lead to loss of motorcycle control and an accident.