

Fitting Instructions:

Speed Triple 1050

Bar End Mirror Kit, Clear Anodised - A9638036

Bar End Mirror Kit, Black Anodised - A9638037



Thank you for choosing this Triumph genuine accessory kit. This accessory kit is the product of Triumph's use of proven engineering, exhaustive testing, and continuous striving for superior reliability, safety and performance.

Completely read all of these instructions before commencing the installation of the accessory kit in order to become thoroughly familiar with the kit's features and the installation process.

These instructions should be considered a permanent part of your accessory kit, and should remain with it even if your accessory equipped motorcycle is subsequently sold.

Caution

These accessory mirrors may not comply with all EC or Federal requirements for rear view mirrors. Fitment for road use is therefore at the owner's own risk.

Warning

This accessory kit is designed for use on Triumph Speed Triple 1050 motorcycles only and should not be fitted to any other Triumph model or to any other manufacturers motorcycle. Fitting this accessory kit to any other Triumph model, or to any other manufacturers motorcycle, may interfere with the rider and could affect the handling, stability or other aspects of the motorcycles operation which may result in loss of motorcycle control and an accident.

Warning

Always have Triumph approved parts, accessories and conversions fitted by a trained technician of an authorised Triumph dealer. The fitment of parts, accessories and conversions by a technician who is not of an authorised Triumph dealer may affect the handling, stability or other aspects of the motorcycles operation which may result in loss of motorcycle control and an accident.

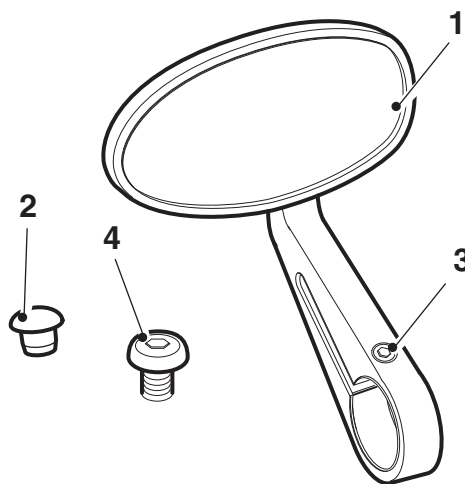

Parts Supplied:

- | | | | |
|--------------------------------|-------|-----------------------------|-------|
| 1. Mirror, bar end | 1 off | 3. Screw, M6 x 20 | 1 off |
| 2. Plug, plastic, M10. | 1 off | 4. Screw, M10 x 12. | 1 off |

Warning

Throughout this operation, ensure that the motorcycle is stabilised and adequately supported on a paddock stand to prevent risk of injury from the motorcycle falling.

Warning

A torque wrench of known accurate calibration must be used when fitting this accessory kit. Failure to tighten any of the fasteners to the correct torque specification may result in loss of motorcycle control and an accident.

Note:

- **The mirror supplied can be fitted to either the left hand, or right hand side of the handlebar. Rotate the mirror head to suit.**

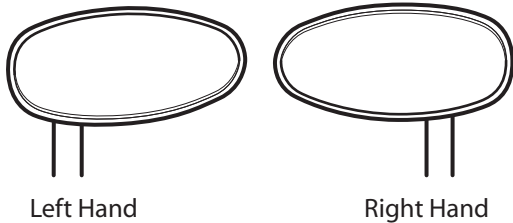

2. Fit the M10 plastic plug provided into the left hand original mirror mounting point threaded hole.

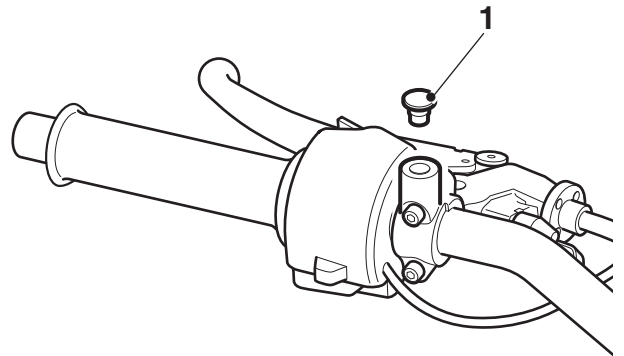

1. M10 plastic plug

3. Ensure the brake fluid reservoir is correctly positioned. Fit the M10 x 12 screw provided, through the brake fluid reservoir bracket, into the right hand original mirror mounting point. Tighten to **25 Nm**.

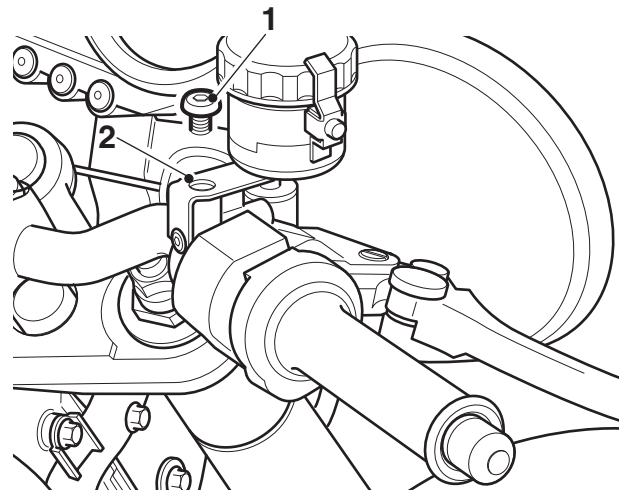

1. Screw, M10 x 12

2. Brake fluid reservoir bracket

Caution

To prevent body damage, do not spill brake fluid onto any area of bodywork.

Note:

- **When the right hand mirror is removed the brake fluid reservoir and it's mounting bracket will become detached. Taking care not to invert the brake fluid reservoir, lay the assembly aside.**

1. Remove the original mirrors from the motorcycle. Pull back the rubber boots, loosen the nuts and unscrew the mirror assemblies. Retain the mirrors if the motorcycle is to be returned to its original condition.



Warning

When fitting the mirror assembly onto the handlebar end weight, ensure there is sufficient clearance between the mirror and throttle grip. Failure to allow clearance could restrict the free movement of the throttle grip and prevent correct throttle operation. Riding a motorcycle when there is any doubt as to any aspect of the performance of the throttle operation may result in loss of control of the motorcycle leading to an accident.



Warning

Operation of the motorcycle with incorrectly adjusted, incorrectly routed or damaged throttle cables could interfere with the operation of the brakes, clutch or the throttle itself. Any of these conditions could result in loss of control of the motorcycle and an accident.



Warning

Move the handlebars to left and right full lock while checking that cables and harnesses do not bind. Cables or harnesses that bind will restrict the steering and may cause loss of control and an accident.



Warning

Ensure that the adjuster locknuts are tightened. A loose throttle cable adjuster could cause the throttle to stick leading to loss of control and an accident.

4. Locate the mirror assembly onto the handlebar end weight. To ensure adequate clearance between the mirror and throttle grip is achieved, pull the throttle grip as far as possible towards the end of the handlebar. Adjust the position of the mirror on the handlebar end weight to ensure there is a minimum of 2 mm clearance between the mirror and throttle grip, as shown below.

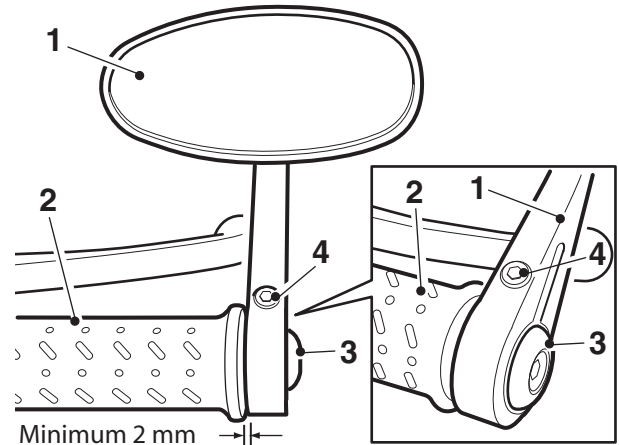

1. Mirror, right hand shown
2. Throttle grip
3. Handlebar end weight
4. Clamp fixing

5. Adjust the mirror assembly to provide clear rear visibility in the normal riding position. Tighten the clamp fixing to **12 Nm**.



Warning

If the mirror fixing is too loose, the mirror may blow back at speed. This will result in a loss of vision to the rear of the motorcycle. It is dangerous to ride a motorcycle without sufficient rearward vision.

6. Remove the paddock stand.

 **Warning**

Check the torque specification of all fasteners and clamp fixings at regular intervals. Failure to tighten any of the fasteners, or clamp fixings, to the correct torque specification could result in movement of the mirror assembly when riding the motorcycle. This may result in loss of motorcycle control and an accident.

 **Warning**

After fitting the accessory kit the motorcycle will exhibit new handling characteristics. Operate the motorcycle in a safe area free from traffic to gain familiarity with any new characteristics. Operation of the motorcycle when not familiar with any new handling characteristics may result in loss of motorcycle control and an accident.

 **Warning**

If, after fitment of this accessory kit, you have any doubt about the performance of any aspect of the motorcycle, contact an authorised Triumph dealer and do not ride the motorcycle until the authorised dealer has declared it fit for use. Riding a motorcycle when there is any doubt as to any aspect of the performance of the motorcycle may result in loss of control of the motorcycle leading to an accident.

 **Warning**

Never ride an accessory equipped motorcycle at speeds above 80 mph (130 km/h).
The presence of accessories will cause changes in the stability and handling of the motorcycle. Failure to allow for changes in motorcycle stability may lead to loss of control or an accident. Remember that the 80 mph (130 km/h) limit will be reduced by the fitting of non-approved accessories, incorrect loading, worn tyres, overall motorcycle condition and poor road or weather conditions.

 **Warning**

Never attempt to clean or adjust mirrors while riding the motorcycle. Removal of the rider's hands from the handlebars while riding the motorcycle will diminish the ability of the rider to maintain control of the motorcycle. Attempting to clean or adjust mirrors while riding the motorcycle may result in loss of control of the motorcycle and an accident.

 **Warning**

The motorcycle must not be operated above the legal road speed limit except in closed course conditions.

 **Warning**

Only operate this Triumph motorcycle at high speed in closed-course on road competition or on closed course racetracks. High speed operation should only be attempted by riders who have been instructed in the techniques necessary for high speed riding and are familiar with the motorcycle's characteristics in all conditions.
High speed operation in any other circumstances is dangerous and will lead to loss of motorcycle control and an accident.