

**Fitting Instructions:  
Speed Triple 1050  
Tail Pack - A9518063**



Thank you for choosing this Triumph genuine accessory kit. This accessory kit is the product of Triumph's use of proven engineering, exhaustive testing, and continuous striving for superior reliability, safety and performance.

Completely read all of these instructions before commencing the installation of the accessory kit in order to become thoroughly familiar with the kit's features and the installation process.

These instructions should be considered a permanent part of your accessory kit, and should remain with it even if your accessory equipped motorcycle is subsequently sold.

**! Warning**

This accessory kit is designed for use on Triumph Speed Triple 1050 motorcycles only and should not be fitted to any other Triumph model or to any other manufacturer's motorcycle. Fitting this accessory kit to any other Triumph model, or to any other manufacturer's motorcycle will affect the performance, stability and handling of the motorcycle. This may affect the riders ability to control the motorcycle and could cause an accident.

**! Warning**

Always have Triumph approved parts, accessories and conversions fitted by a trained technician of an authorised Triumph dealer. The fitment of parts, accessories and conversions by a technician who is not of an authorised Triumph dealer may affect the handling, stability or other aspects of the motorcycles operation which may result in loss of motorcycle control and an accident.

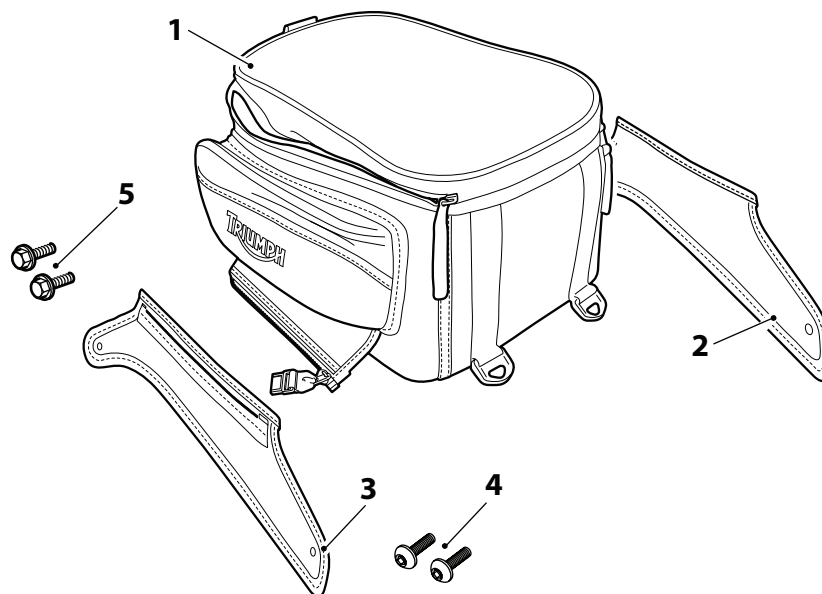

**Parts Supplied:**

- |                                     |       |                             |       |
|-------------------------------------|-------|-----------------------------|-------|
| 1. Tail pack . . . . .              | 1 off | 4. Screw, M5 x 16 . . . . . | 2 off |
| 2. Side mount, left hand . . . . .  | 1 off | 5. Bolt, M6 x 12 . . . . .  | 2 off |
| 3. Side mount, right hand . . . . . | 1 off |                             |       |

**! Warning**

Throughout this operation, ensure that the motorcycle is stabilised and adequately supported on a paddock stand to prevent risk of injury from the motorcycle falling.

**! Warning**

A torque wrench of known accurate calibration must be used when fitting this accessory kit. Failure to tighten any of the fasteners to the correct torque specification may result in loss of motorcycle control and an accident.

**! Warning**

Remove all shoulder straps from the tail pack before mounting the tail pack to the motorcycle. Operation of the motorcycle with the shoulder straps fitted may result in loss of motorcycle control and an accident.

1. Remove the seat.
2. Remove the seat hand strap. Retain the hand strap and fixings for reuse.
3. Locate the left hand side mount and retain with the new M6 x 12 bolt provided. Ensure the side fixing is around, not over, the rubber seat grommet as shown. Tighten the fixing screw to **3 Nm**.

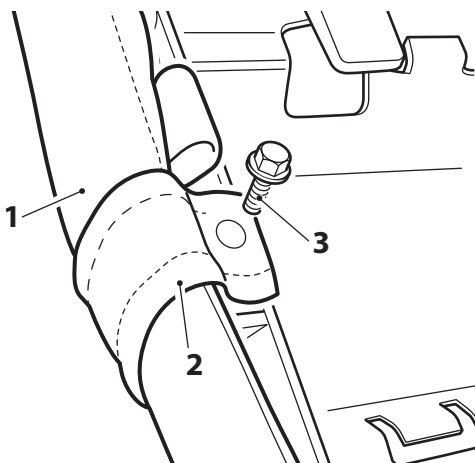

1. Seat
2. Hand strap
3. Fixing, left hand shown

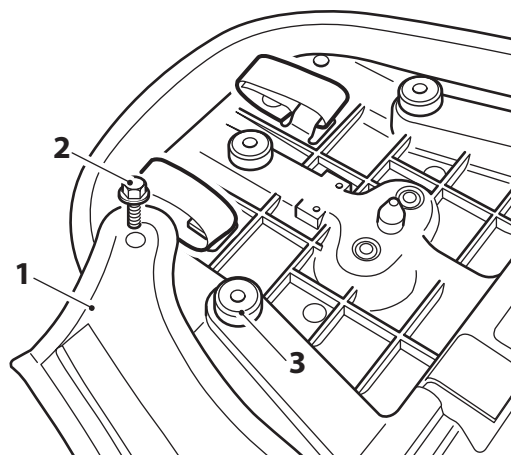

1. Side mount, left hand shown
2. Bolt, M6 x 12
3. Rubber grommet

4. Fold the side mount around the seat and align the side mount front fixing position with the mounting boss on the seat. Retain with a new M5 x 16 screw provided. Tighten the screw to **3 Nm**.

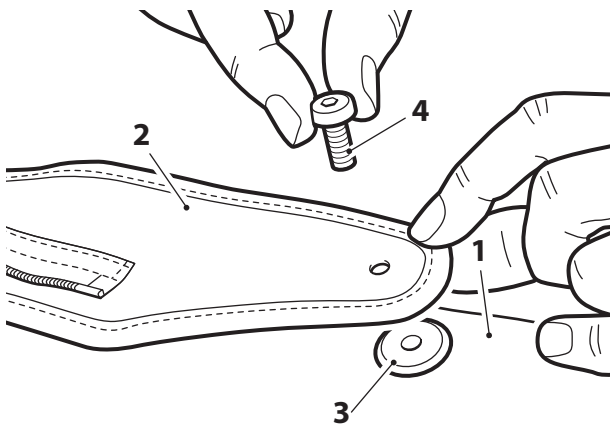

1. Seat
2. Side mount, left hand shown
3. Mounting boss
4. Screw, M5 x 16

5. Repeat the procedure for the right hand side mount.
6. Refit the seat hand strap, over the side mounts, and secure with the original fixings. Tighten the fixings to **10 Nm**.

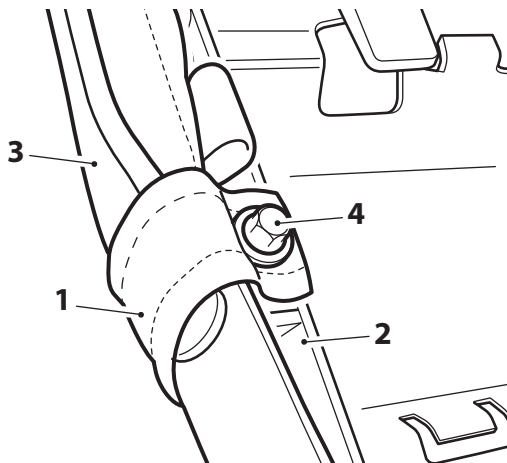

1. Hand strap
2. Seat
3. Side mount, left hand shown
4. Fixing

### Installing the Tail Pack

7. Position the tail pack on the seat and retain to the side mounts with the two zips. Always ensure the zips are clipped into the quick release fasteners as shown below.

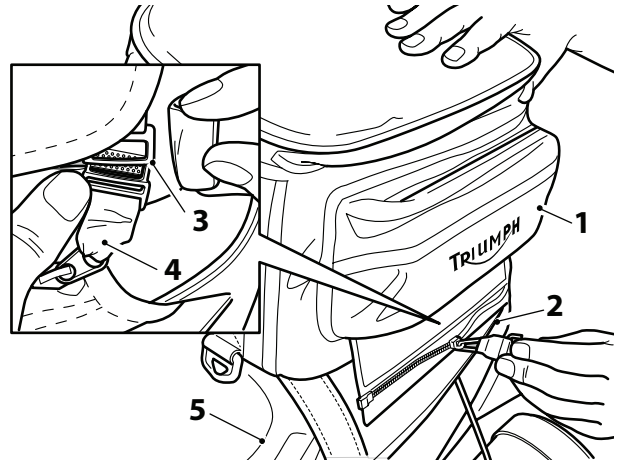

1. Tail pack
2. Side mount
3. Quick release fastener
4. Zip
5. Seat

---

 **Warning**

After fitting the accessory kit the motorcycle will exhibit new handling characteristics. Operate the motorcycle in a safe area free from traffic to gain familiarity with any new characteristics. Operation of the motorcycle when not familiar with any new handling characteristics may result in loss of motorcycle control and an accident.

 **Warning**

If, after fitment of this accessory kit, you have any doubt about the performance of any aspect of the motorcycle, contact an authorised Triumph dealer and do not ride the motorcycle until the authorised dealer has declared it fit for use. Riding a motorcycle when there is any doubt as to any aspect of the performance of the motorcycle may result in loss of control of the motorcycle leading to an accident.

 **Warning**

The maximum safe load for the tail pack is 3 kg (6 lbs). Never exceed this loading limit as this may cause the motorcycle to become unstable leading to loss of control and an accident.

 **Warning**

Never ride an accessory equipped motorcycle (including those fitted with Triumph approved windscreens and luggage systems) at speeds above 80 mph (130 km/h).

The presence of accessories such as windscreens and luggage systems will cause changes in the stability and handling of the motorcycle. Failure to allow for changes in motorcycle stability may lead to loss of control or an accident.

Remember that the 80 mph (130 km/h) limit will be reduced by the fitting of non-approved accessories, incorrect loading, worn tyres, overall motorcycle condition and poor road or weather conditions.

 **Warning**

The motorcycle must not be operated above the legal road speed limit except in closed course conditions.

 **Warning**

Only operate this Triumph motorcycle at high speed in closed-course on road competition or on closed course racetracks. High speed operation should only be attempted by riders who have been instructed in the techniques necessary for high speed riding and are familiar with the motorcycle's characteristics in all conditions.

High speed operation in any other circumstances is dangerous and will lead to loss of motorcycle control and an accident.